

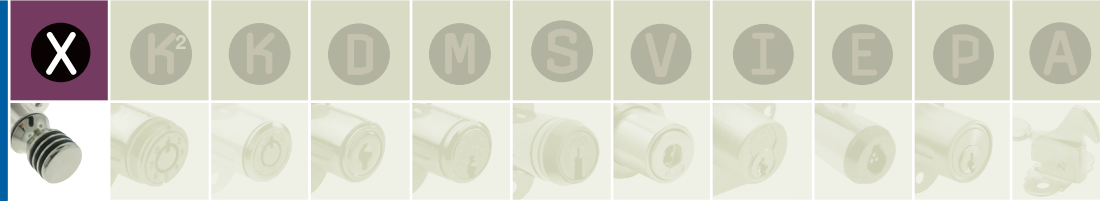

Knob/Coin Line of Locks



Introduction	$\frac{X}{1}$				
Cam Locks	$\frac{X}{2}$ $\frac{X}{3}$				
Drawer/Door Locks	$\frac{X}{4}$				
Snap Bolt Lock	$\frac{X}{5}$				
Plunger Lock PL40	$\frac{X}{6}$				
Plunger Lock PL45	$\frac{X}{7}$				
Plunger Lock PL50	$\frac{X}{8}$				



KNOB



COIN

New



Knob Line of Locks

Standard Plating Finish



* Special Plating Finishes



* Custom Plating Finish

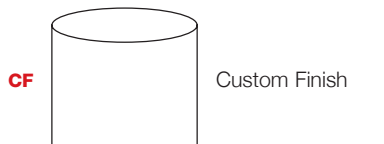

Kenstan is proud to introduce the expansion of our Knob **X** line of locks. Within our **X** line, you can now order our Coin **C** Line of Locks. These locks includes cam locks, drawer locks, door locks, and plunger locks. **Delivery**

At Kenstan, we assemble every lock to order and strive to meet your requested in-house date. Our standard lead time is to ship within two weeks from the receipt of your order. Rush orders and emergency services are available.

Plating

The **X/C** line standard plating finish is Polished Nickel.

A wide range of special plating finishes is also available, including Satin Nickel, Polished Brass, Satin Brass, Statuary Bronze, Matte Black and Custom Finishes to match your showcase hardware.

Please note: Extended lead-time and plating lot charges may apply to Special and Custom finishes. Please call Kenstan for details.

* Extended lead-time and plating lot charges may apply to Special and Custom finishes. Please call Kenstan for details.

Item Number

To determine your item number enter the **RED** option code for each section as in the example below.

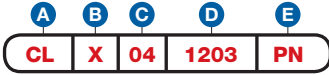

A Lock Style

CL Cam Lock

B Core Type

X Knob
New **C** Coin

C Housing Length

MAXIMUM MATERIAL THICKNESS

	WOOD	METAL	GLASS	BARREL LENGTH
04	13/16"	7/8"	11/16"	1-1/8"
05	1"	1-1/16"	7/8"	1-3/8"
06	1-5/16"	1-7/16"	1-1/4"	1-11/16"

D Cam Rotation

	LOCKED	OPEN
0312	3	12
0306	3	6
0309	3	9
0603	6	3
0612	6	12
0609	6	9
0912	9	12
0903	9	3
0906	9	6
1203	12	3
1206	12	6
1209	12	9

E Plating Finish

Extended lead-time and plating lot charges **may** apply to Special and Custom finishes.

Special Finish

PN	Polished Nickel
SN	Satin Nickel
PB	Polished Brass
SB	Satin Brass
BL	Matte Black
ST	Statuary Bronze
CF	Custom Finish

F Material Installation

W	Wood
M	Metal
GR	Glass with Round Hole
GD	Glass with Double "D" Hole
O	Other - No Mounting Hardware

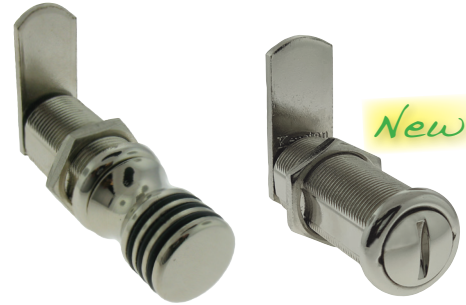

All Cam Locks come with a 1-1/4" Straight Cam unless a different cam is chosen.

G Cam Type

STRAIGHT

101	5/8"
102	3/4"
103	7/8"
104	1"
105	1-1/8"
106	1-1/4"
107	1-3/8"
108	1-1/2"
110	1-3/4"
112	2"
116	2-1/2"

1/8" OFFSET

303	7/8"
306	1-1/4"
308	1-1/2"
312	2"

1/4" OFFSET

403	7/8"
404	1"
406	1-1/4"
408	1-1/2"
410	1-3/4"
412	2"
414	2-1/4"

3/8" OFFSET

504	1"
506	1-1/4"
508	1-1/2"
512	2"

1/2" OFFSET

606	1-1/4"
608	1-1/2"
610	1-3/4"
612	2"

5/8" OFFSET

712	2"
------------	----

HOOK

202	3/4"
204	1"
206	1-1/4"
208	1-1/2"
210	1-3/4"

CUSTOM CAM

CL

Continued



B CORE TYPE

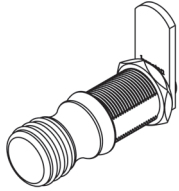

Knob

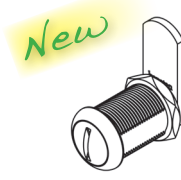

Coin

C HOUSING LENGTH 04, 05 and 06

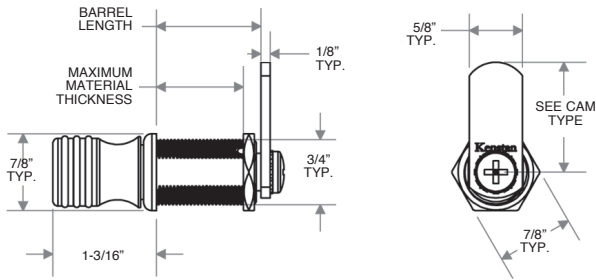

Knob core type shown

D CAM ROTATION EXAMPLE

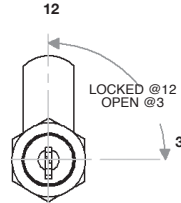

All 180 degree rotations are clockwise, unless specified.

F WOOD INSTALLATION W

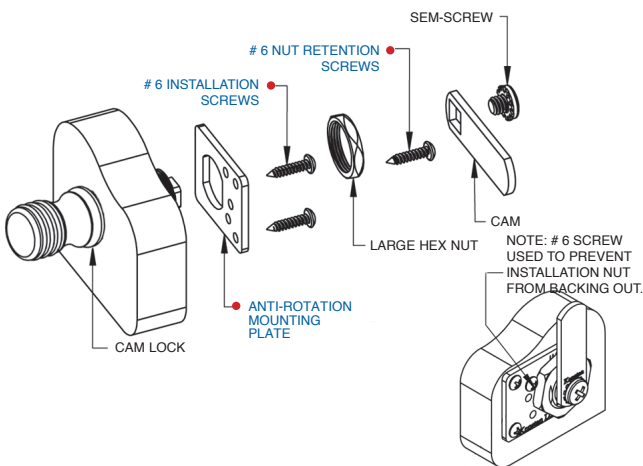

F METAL INSTALLATION M

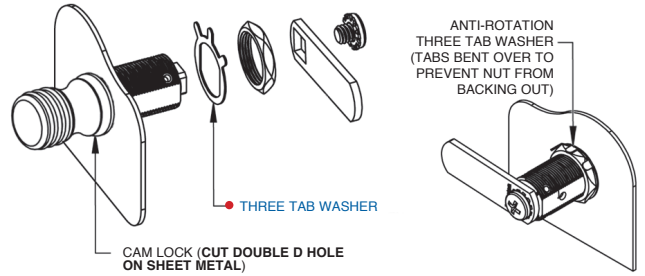

F GLASS INSTALLATION - ROUND HOLE GR

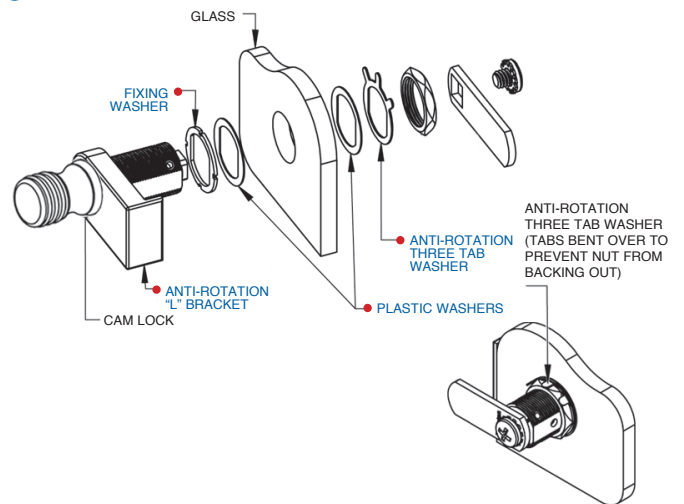

Dimension from center of hole to the edge of glass is 1-1/4"

F GLASS INSTALLATION - DOUBLE D HOLE GD

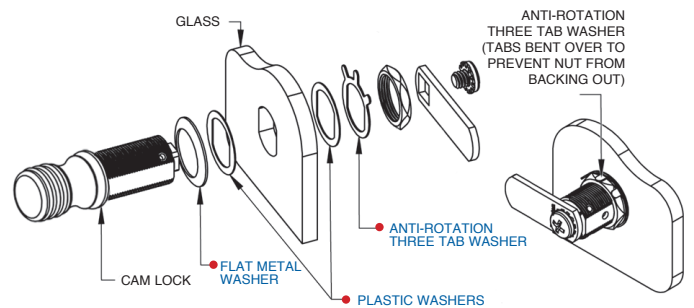

G CAM TYPES

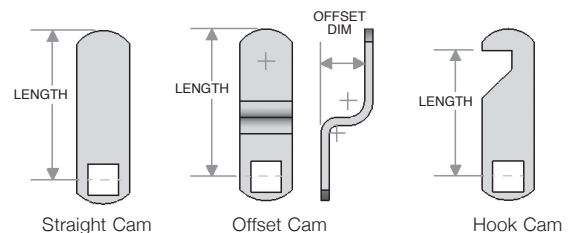

Note: All Offset cams are reversible.

Item Number

To determine your item number enter the **RED** option code for each section as in the example below.

A	B	C	D	E
DL	X	S	3029	PN

A Lock Style

DL Drawer/Door Lock

B Core Type

X Knob
New **C** Coin

C Housing Length

S 13/16"
M 1-1/16"
L 1-3/16"

D Bolt Type

STRAIGHT BOLT

2001 1-1/16"
2002 1-11/16"
2003 2-5/16"
2004 3-1/8"

3/8" OFFSET BOLT

2205 1-5/8"

DIECAST SPRING BOLT

3209 1-5/16" Std.

INVERTED SLIDING SPRING BOLT

3410 1-5/16" Left
3411 1-5/16" Right

E Plating Finish

Extended lead-time and plating lot charges may apply to Special and Custom finishes.

Special Finish	PN	Polished Nickel
	SN	Satin Nickel
	PB	Polished Brass
	SB	Satin Brass
	BL	Matte Black
	ST	Statuary Bronze
	CF	Custom Finish



"Throw" (distance bolt travels from the locked to unlocked position) is 5/16".
All dimensions shown are in the locked position.

B CORE TYPE

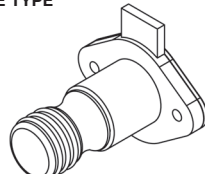

Knob

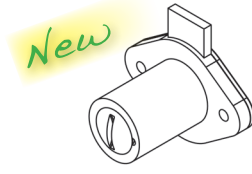

Coin

D STRAIGHT BOLT

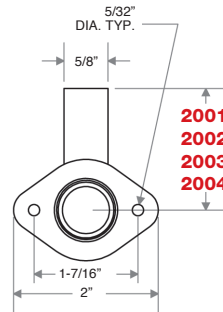

C HOUSING LENGTH

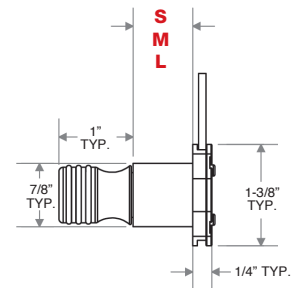

D 3/8" OFFSET BOLT



D DIECAST SPRING BOLT (3/16" bolt engagement recommended)

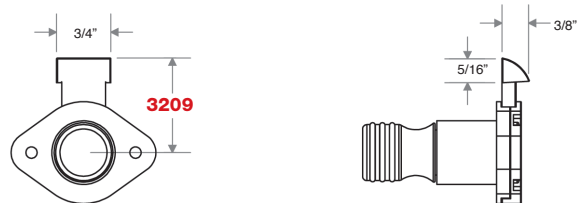

D INVERTED SLIDING SPRING BOLT

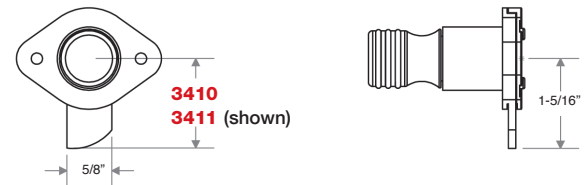

Price List and Data Sheet

Item Number

To determine your item number enter the **RED** option code for each section as in the example below.

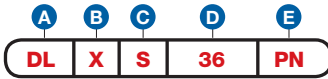

A Lock Style
DL Drawer/Door Lock

B Core Tyoe
X Knob
New **C** Coin

C Housing Length/Style

STANDARD
S 13/16"
M 1-1/16"
L 1-3/16"

LOW PROFILE
SL 13/16"

D Bolt Type
SNAP BOLT
36 3/4"

E Plating Finish
 Extended lead-time and plating lot charges may apply to Special and Custom finishes.

Special Finish { **PN** Polished Nickel
SN Satin Nickel
PB Polished Brass
SB Satin Brass
BL Matte Black
ST Statuary Bronze
CF Custom Finish

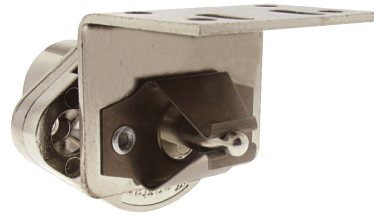

All dimensions shown are in the locked position.

B CORE TYPE

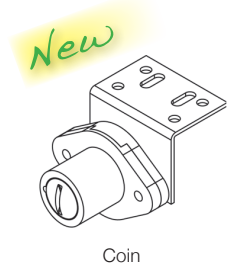
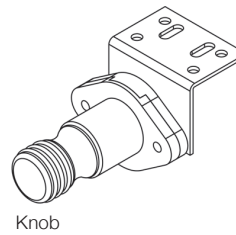

D STANDARD SNAP BOLT

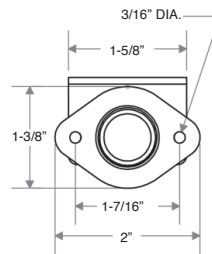

C HOUSING LENGTH

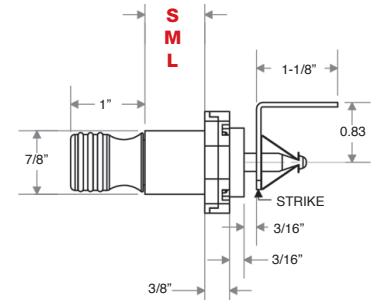

D LOW PROFILE SNAP BOLT

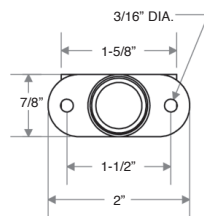

C HOUSING LENGTH

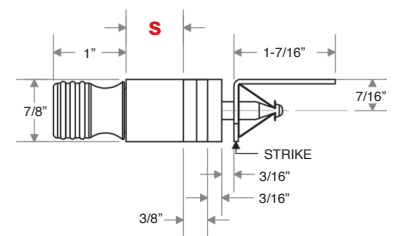



Item Number

To determine your item number enter the RED option code for each section as in the example below.

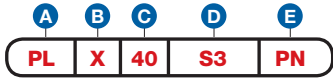

A Lock Style

PL Plunger Lock

B Core Type

X Knob
New C Coin

C Housing Style

40 Oval Flange

D Plunger Type/Length

S SERIES

S1 3/8"
S2 7/16"
S3 5/8"

T SERIES

T1 1/4"
T3 9/16"

ROUND SERIES

R1 3/8"
R2 7/16"
R3 5/8"

ROUND EXTENDED SERIES

R4 1-3/16"
R5 1-5/16"
R6 1-11/16"
R7 2-7/16"

E Plating Finish

Extended lead-time and plating lot charges may apply to Special and Custom finishes.

Special Finish	PN	Polished Nickel
	SN	Satin Nickel
	PB	Polished Brass
	SB	Satin Brass
	BL	Matte Black
	ST	Statuary Bronze
	CF	Custom Finish



All dimensions shown are in the locked position.

B CORE TYPE

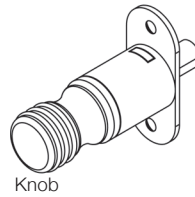

Knob

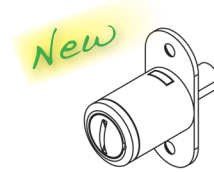

Coin

D S SERIES

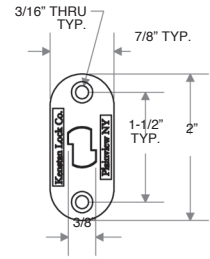
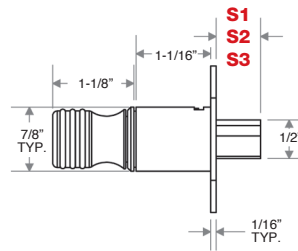

D T SERIES

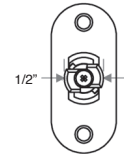
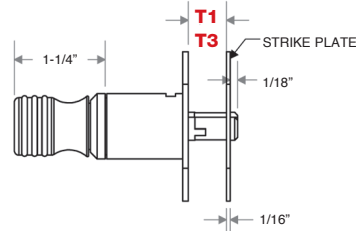

D ROUND SERIES

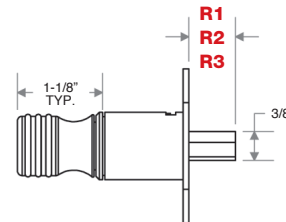

D ROUND EXTENDED SERIES (Plunger travels 5/8")

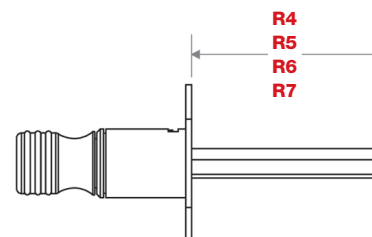

Price List and Data Sheet

Item Number

To determine your item number enter the **RED** option code for each section as in the example below.

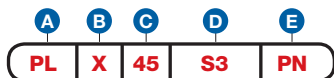

A Lock Style

PL Plunger Lock

B Core Type

X Knob
New **C** Coin

C Housing Style

45 No Flange

D Plunger Type/Length

S SERIES

S1 5/16"
S2 7/16"
S3 5/8"

T SERIES

T1 1/4"
T3 9/16"

ROUND SERIES

R1 5/16"
R2 7/16"
R3 5/8"

ROUND EXTENDED SERIES

R4 1-3/16"
R5 1-5/16"
R6 1-11/16"
R7 2-7/16"

E Plating Finish

Extended lead-time and plating lot charges may apply to Special and Custom finishes.

Special Finish	PN	Polished Nickel
	SN	Satin Nickel
	PB	Polished Brass
	SB	Satin Brass
	BL	Matte Black
	ST	Statuary Bronze
	CF	Custom Finish



All dimensions shown are in the locked position.

B CORE TYPE

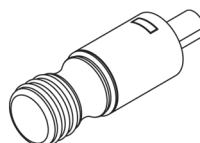

Knob



Coin

D S SERIES

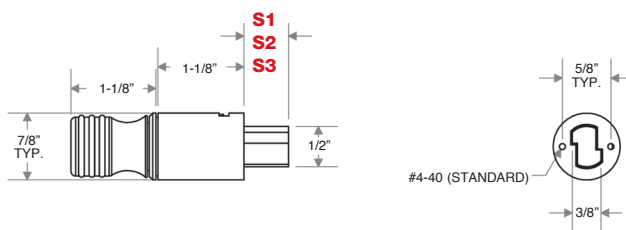

D T SERIES

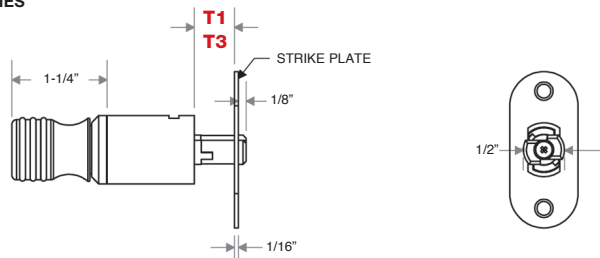

D ROUND SERIES

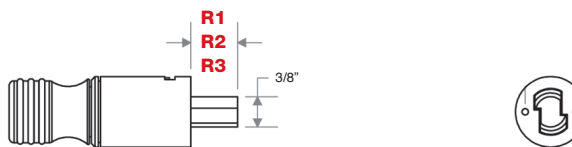

D ROUND EXTENDED SERIES (Plunger travels 5/8")

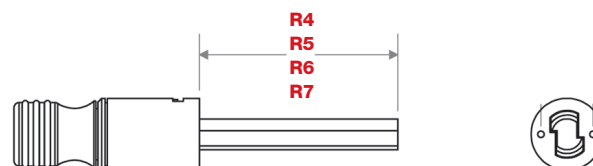



Item Number

To determine your item number enter the **RED** option code for each section as in the example below.

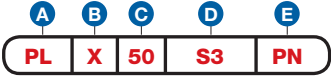

A Lock Style

PL Plunger Lock

B Core Tyoe

X Knob
New **C** Coin

C Housing Style

50 Round Flange

D Plunger Type/Length

S SERIES

S1 3/8"
S2 7/16"
S3 5/8"

T SERIES

T1 1/4"
T3 9/16"

L SERIES

L3 3/8"

ROUND SERIES

R1 3/8"
R2 7/16"
R3 5/8"

ROUND EXTENDED SERIES

R4 1-3/16"
R5 1-5/16"
R6 1-11/16"
R7 2-7/16"

E Plating Finish

Extended lead-time and plating lot charges may apply to Special and Custom finishes.

Special Finish	PN	Polished Nickel
	SN	Satin Nickel
	PB	Polished Brass
	SB	Satin Brass
	BL	Matte Black
	ST	Statuary Bronze
	CF	Custom Finish



All dimensions shown are in the locked position.

B CORE TYPE

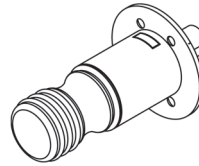

Knob



Coin

D S SERIES (Parts included same as Round Series)

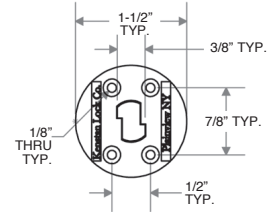
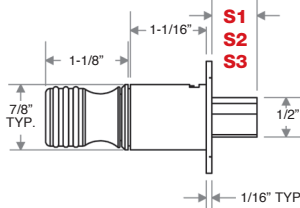

D T SERIES

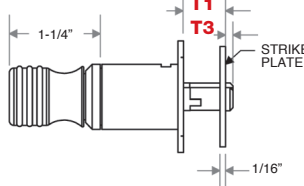

PARTS INCLUDED	QTY.
(a) DOUGHNUT	2
(b) J BRACKET (anti-rotation)	1
(c) PLASTIC WASHER	4
(d) PLASTIC SPACER	2
(e) SCREW	8
(f) STRIKE PLATE	1

D L SERIES

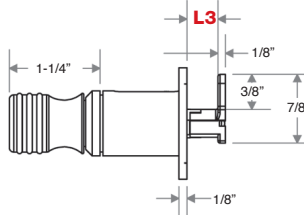

PARTS INCLUDED	QTY.
(a) DOUGHNUT	1
(b) J BRACKET (anti-rotation)	1
(c) PLASTIC WASHER	2
(d) PLASTIC SPACER	1
(e) SCREW	4

D ROUND SERIES (Plunger travels 5/8")

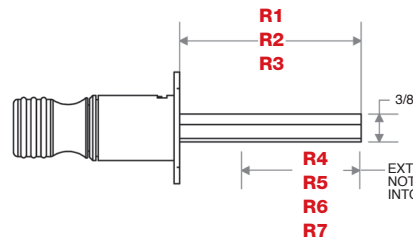

PARTS INCLUDED	QTY.
(a) DOUGHNUT	1
(c) PLASTIC WASHER	2
(d) PLASTIC SPACER	1
(e) SCREW	4

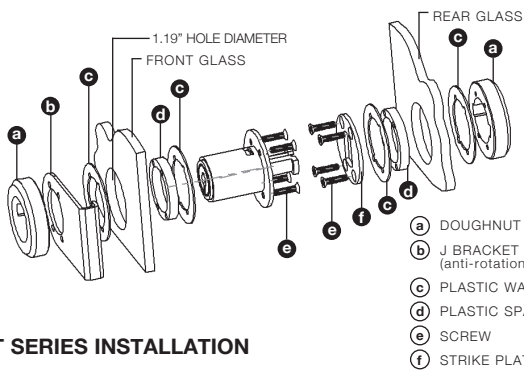

T SERIES INSTALLATION

- (a) DOUGHNUT
- (b) J BRACKET (anti-rotation)
- (c) PLASTIC WASHER
- (d) PLASTIC SPACER
- (e) SCREW
- (f) STRIKE PLATE

- 1. Pricing:** Kenstan Lock reserves the right to institute price adjustments based upon fluctuation of material costs without prior notice. Orders, or balances of orders, that have not shipped within 6 months from the original order date may be subject to a price review.
- 2. Payment Terms:** Payment must be made at time of purchase, unless otherwise approved by Kenstan with terms of Net 30 Days from the date of the invoice. A service charge of 1.5% per month will be charged on overdue accounts.
- 3. Shipping:** Please be sure to specify your preferred shipping method on every order. For all orders received without shipping instructions, Kenstan will use our discretion to make carrier selection based upon the most economical method of shipment available to meet your required in house date. Kenstan is not responsible for risk of loss or damage to products in transit with the selected carrier.
- 4. Deliveries:** At Kenstan, we assemble every lock to order and strive to meet your requested in-house date. Our standard lead time is to ship within two weeks from the receipt of your order. Rush orders and emergency services are available. Unless specifically prohibited in writing by the purchaser, Kenstan reserves the right to make partial shipments of any order.
- 5. Inspection:** Kenstan Lock inspects all products in accordance with our standard quality control procedures. Upon receipt and inspection by the purchaser, any parts proven to be defective or not as ordered may be returned to Kenstan for repair or replacement following the conditions in the "Returned Goods" section (#6) below.
- 6. Returned Goods:** Product replacement or account credit for any returned goods will be made solely at the discretion of Kenstan and will only be accepted upon the issuance of a Return Authorization number from Kenstan's Customer Service Department. Merchandise proven to be defective, due to faulty material and/or workmanship, may be returned for full replacement or credit. Any product ordered incorrectly by the customer may be accepted for return and subject to a 50% handling charge. Locks made with special or out-of production parts are not returnable, unless prior arrangements have been made. Returned merchandise that is damaged in transit, due to inadequate return packaging, will not be accepted.
- 7. Warranty:** Kenstan Lock warrants, for a period of one year from delivery, that our products are free from defects in material and workmanship and makes no other warranties, expressed or implied, including but not limited to the degree of security or the purchaser's application or use of our product. Kenstan Lock Co. will not warranty any locks or parts that were modified outside of our factory. In the event of a product defect, Kenstan shall only be responsible to the extent of the cost of our product, and will not accept any claims for labor or loss of merchandise.
- 8. Cancellation:** If all or any part of an order is cancelled before the completion of the product assembly by Kenstan, the purchaser shall be responsible for payment of all assembled items as well as any special parts ordered for items remaining unassembled at the time of cancellation. If pricing on the original order was based upon Kenstan's quantity discount, a partial cancellation may affect the pricing on items already shipped and invoiced and a price adjustment will be made.
- 9. Catalog Dimensions and Sample Policy:** Please be aware that all lock and part drawing dimensions carry a tolerance of plus or minus 1/16" and are for reference only. Please contact us for actual dimensions. All specifications are subject to change without notice. Samples products are available upon request.