

## Item Number

To determine your item number enter the **RED** option code for each section as in the example below.

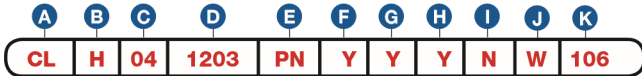

### A Lock Style

**CL** Cam Lock

### B Core Type

**M** Medeco® Biaxial  
**H** Medeco® Biaxial m<sup>3</sup>  
**R** Medeco® Biaxial - Removable Core  
**G** Medeco® Biaxial m<sup>3</sup> - Removable Core

### C Housing Length

#### MAXIMUM MATERIAL THICKNESS

	WOOD	METAL	GLASS	BARREL LENGTH
<b>02</b>	-	3/8"	1/4"	1 1/16"
<b>03</b>	1/2"	9/16"	7/16"	7/8"
<b>04*</b>	13/16"	7/8"	3/4"	1-1/8"
<b>05</b>	1-3/16"	1-1/4"	1-1/8"	1-1/2"
<b>10</b>	1-9/16"	-	-	1-3/4"
<b>11</b>	1-7/8"	-	-	2"
<b>12</b>	2-1/4"	-	-	2-3/8"
<b>13</b>	2-1/2"	-	-	2-3/4"
<b>14</b>	2-3/4"	-	-	3"
<b>15</b>	3-1/8"	-	-	3-3/8"

### D Cam Rotation

	LOCKED	OPEN	LOCKED	OPEN
<b>0312</b>	3	12	<b>0912</b> 9	12
<b>0306</b>	3	6	<b>0903</b> 9	3
<b>0309</b>	3	9	<b>0906</b> 9	6
<b>0612</b>	6	12	<b>1203</b> 12	3
<b>0603</b>	6	3	<b>1206</b> 12	6
<b>0609</b>	6	9	<b>1209</b> 12	9

### E Plating Finish

Extended lead-time and plating lot charges may apply to Special and Custom finishes.

Special Finish	Code	Description
	<b>PN</b>	Polished Nickel w/Satin Chrome Core
	<b>PB</b>	Polished Brass
	<b>SB</b>	Satin Brass
	<b>BL</b>	Matte Black
	<b>ST</b>	Statuary Bronze
	<b>CF</b>	Custom Finish

### F Key Retaining

**N\*** No  
**Y** Yes

### G Keyed Different

**N** No  
**Y** Yes

### H Stamp Lock

**N** No  
**Y** Yes

### I Master Keyed

**N** No  
**Y** Yes  
**G** Grand Master

### J Material Installation

**W** Wood  
**M** Metal  
**GR** Glass with Round Hole  
**GD** Glass with Double "D" Hole  
**O** Other - No Mounting Hardware



**Note:** All Cam Locks come with a 1-1/4" Straight Cam unless a different cam is chosen.

### K Cam Type

#### STRAIGHT

<b>101</b>	5/8"
<b>102</b>	3/4"
<b>103</b>	7/8"
<b>104</b>	1"
<b>105</b>	1-1/8"
<b>106</b>	1-1/4"
<b>107</b>	1-3/8"
<b>108</b>	1-1/2"
<b>110</b>	1-3/4"
<b>112</b>	2"
<b>116</b>	2-1/2"

#### 1/8" OFFSET

<b>303</b>	7/8"
<b>306</b>	1-1/4"
<b>308</b>	1-1/2"
<b>312</b>	2"

#### 1/4" OFFSET

<b>403</b>	7/8"
<b>404</b>	1"
<b>406</b>	1-1/4"
<b>408</b>	1-1/2"
<b>410</b>	1-3/4"
<b>412</b>	2"
<b>414</b>	2-1/4"

#### 3/8" OFFSET

<b>504</b>	1"
<b>506</b>	1-1/4"
<b>508</b>	1-1/2"
<b>512</b>	2"

#### 1/2" OFFSET

<b>606</b>	1-1/4"
<b>608</b>	1-1/2"
<b>610</b>	1-3/4"
<b>612</b>	2"

#### 5/8" OFFSET

<b>712</b>	2"
------------	----

#### HOOK

<b>202</b>	3/4"
<b>204</b>	1"
<b>206</b>	1-1/4"
<b>208</b>	1-1/2"
<b>210</b>	1-3/4"

#### PIN CAM

**P604** 9/16" offset

#### FOR SWITCH KIT

**SL** No Cam\*

\*Switch option available. See Page A10 to order switch kit.

**Continued**



**HOUSING LENGTHS 02 and 03**

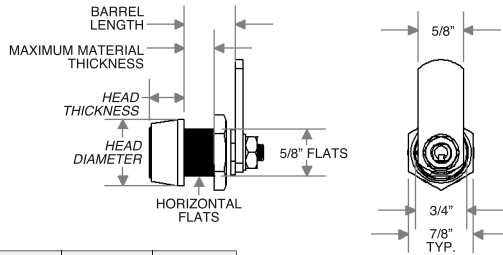

CORE TYPE	HOUSING LENGTH	HEAD THICKNESS	HEAD DIAMETER
M & H	02	1/2"	1"
M & H	03	3/8"	7/8"
G & R	02	11/16"	1"
G & R	03	7/16"	1"

**HOUSING LENGTH 04 and 05**

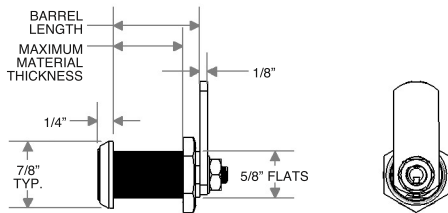

**HOUSING LENGTHS 10, 11, 12, 13, 14 and 15**

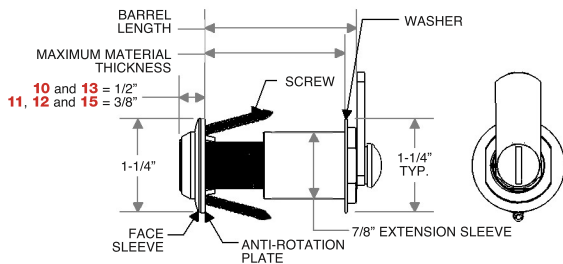

**CAM ROTATIONS EXAMPLE**

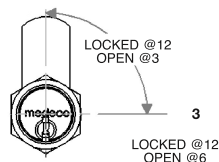

All non-key retaining 90 degree rotations are custom - call Kenstan.  
All 180 degree rotations are clockwise, unless specified.

**J WOOD INSTALLATION W**

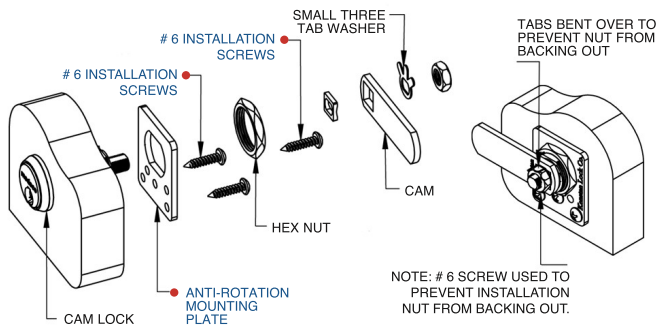

**J METAL INSTALLATION M**

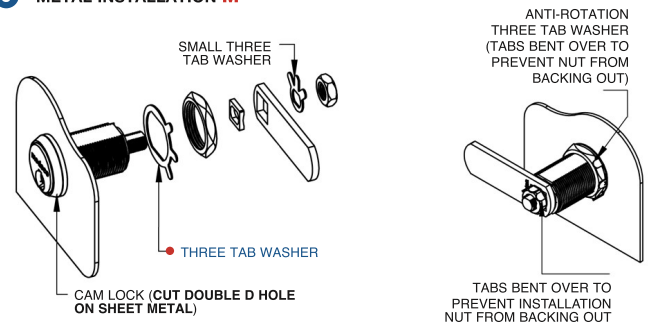

**J GLASS INSTALLATION - ROUND HOLE GR**

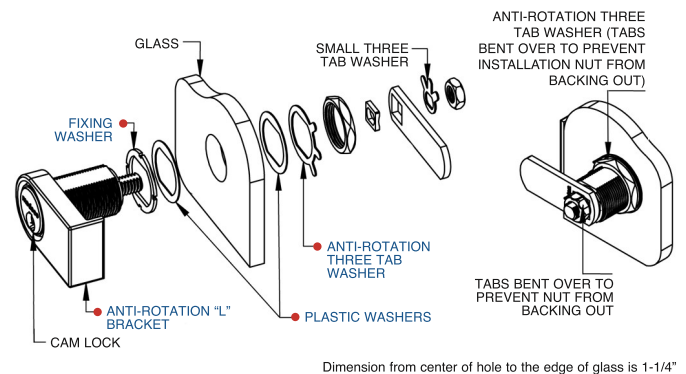

**J GLASS INSTALLATION - DOUBLE D HOLE GD**

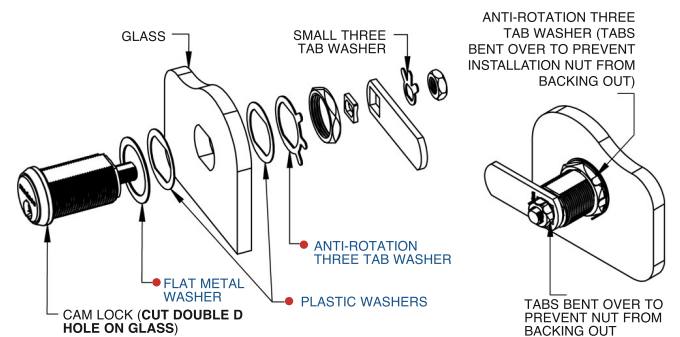

**K CAM TYPES**

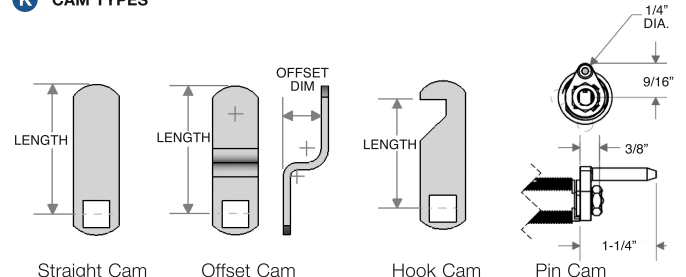

Note: All Offset cams are reversible.