

## I.C. CORE CAM LOCK GLASS INSTALLATION PACKAGE



**CLILK BC** A kit with one "L" bracket and two plastic washers.

**A Package**  
**CLILK**

**B Plating Finish**

<b>PC</b>	Polished Chrome
<b>BC</b>	Brush Chrome
<b>PB</b>	Polished Brass
<b>BL</b>	Matte Black
<b>CF</b>	Custom Finish

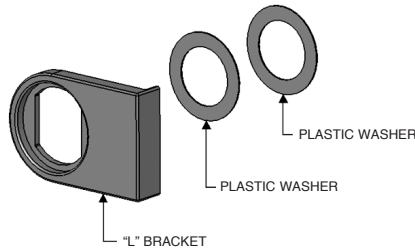

## UNIVERSAL SWITCH KIT (Lock, three tab washers and nuts not included)

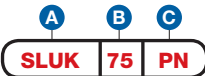

Two position maintained switch (Not Spring Loaded) Double pole double throw Toggle Switch rated 10amp/250VAC, with screw terminal.

**A Package**  
**SLUK**

**B Material Thickness**

<b>75</b>	3/4"
<b>O</b>	Other

**C Plating Finish**

<b>PN</b>	Polished Nickel
<b>SN</b>	Satin Nickel
<b>PB</b>	Polished Brass
<b>CF</b>	Custom Finish

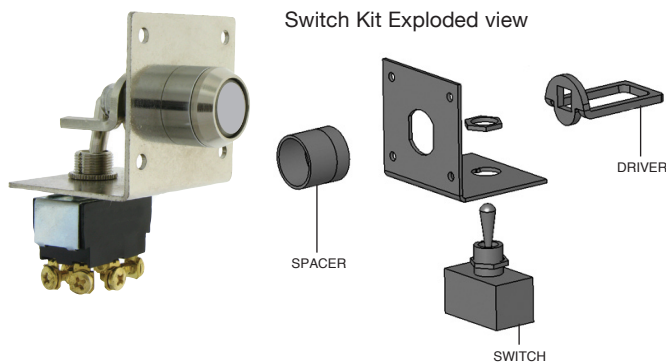

If a particular accessory is not shown in our catalog, please contact Kenstan for assistance. Kenstan may have the part as a non-catalog item or we will modify an existing part to meet your specific application. We offer prompt service in the development and quoting of custom accessory parts.

## CAM TYPE

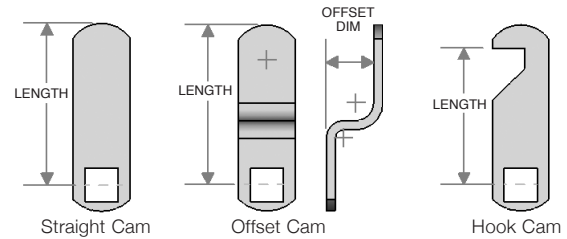

**Note:** All cams are reversible.

Made in the U.S.A

## CAM TYPE

## STRAIGHT CAM

<b>CAM 101</b>	5/8"
<b>CAM 102</b>	3/4"
<b>CAM 103</b>	7/8"
<b>CAM 104</b>	1"
<b>CAM 105</b>	1-1/8"
<b>CAM 106</b>	1-1/4"
<b>CAM 107</b>	1-3/8"
<b>CAM 108</b>	1-1/2"
<b>CAM 110</b>	1-3/4"
<b>CAM 112</b>	2"
<b>CAM 116</b>	2-1/2"

## 1/8" OFFSET CAM

<b>CAM 303</b>	7/8"
<b>CAM 306</b>	1-1/4"
<b>CAM 308</b>	1-1/2"
<b>CAM 312</b>	2"

## 1/4" OFFSET CAM

<b>CAM 403</b>	7/8"
<b>CAM 404</b>	1"
<b>CAM 406</b>	1-1/4"
<b>CAM 408</b>	1-1/2"
<b>CAM 410</b>	1-3/4"
<b>CAM 412</b>	2"
<b>CAM 414</b>	2-1/4"

## 3/8" OFFSET CAM

<b>CAM 504</b>	1"
<b>CAM 506</b>	1-1/4"
<b>CAM 508</b>	1-1/2"
<b>CAM 512</b>	2"

## 1/2" OFFSET CAM

<b>CAM 606</b>	1-1/4"
<b>CAM 608</b>	1-1/2"
<b>CAM 610</b>	1-3/4"
<b>CAM 612</b>	2"

## 5/8" OFFSET CAM

<b>CAM 712</b>	2"
----------------	----

## HOOK CAM

<b>CAM 202</b>	3/4"
<b>CAM 204</b>	1"
<b>CAM 206</b>	1-1/4"
<b>CAM 208</b>	1-1/2"
<b>CAM 210</b>	1-3/4"

## CUSTOM CAM

**CL CL**

Made in the U.S.A