



Item Number

To determine your item number enter the RED option code for each section as in the example below.



A Lock Style

DL Drawer/Door Lock

B Core Type

V ABLOY® EXEC
V3 ABLOY® SENTRY
V4 ABLOY® PROTEC

C Housing Length

L 1-3/16"

D Bolt Type

STRAIGHT BOLT

2001 1-1/8"
2002 1-3/4"
2003 2-3/8"
2004 3-3/16"

3/8" OFFSET BOLT

2205 1-11/16"

DIECAST SPRING BOLT

3209 1-3/8" Std.

INVERTED SLIDING SPRING BOLT

3410 1-3/8" Left
3411 1-3/8" Right

E Plating Finish

Extended lead-time and plating lot charges may apply to Special and Custom finishes.

Table with 2 columns: Special Finish (PC, SC, PB, BL, ST, CF) and description (Polished Chrome, Satin Chrome, Polished Brass, Matte Black, Statuary Bronze, Custom Finish)

F Key Retaining

*Option available only on Spring Bolt models.

N* No
Y Yes

G Keyed Different

N No
Y Yes

H Stamp Lock

N No
Y Yes

I Master Keyed

N No
Y Yes
G Grand Master
GA Great Grand Master



Pat. Pending

"Throw" (distance bolt travels from the locked to unlocked position) is 7/16".

All dimensions shown are in the locked position.

D STRAIGHT BOLT

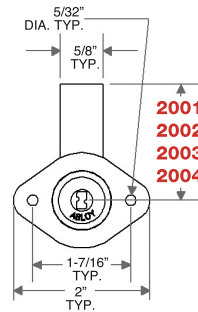

C HOUSING LENGTH

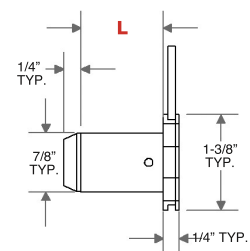

D 3/8" OFFSET BOLT

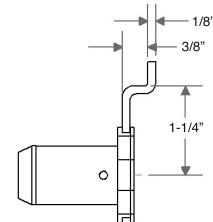
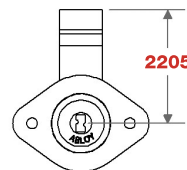

D DIECAST SPRING BOLT (3/16" bolt engagement recommended)

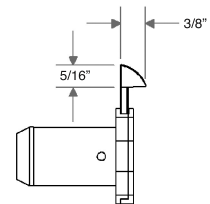
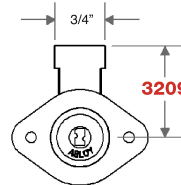

D INVERTED SLIDING SPRING BOLT

